



## INSPECTION REPORT

To:	XXXXX	Attn:	XXX XXX
From:	XXX	Report Date:	xx-xx-2011

Vendor Name	: XXXXX
Factory Name	: XXXXX
Factory Address	: XXXXX
Order No. / PO No.	: S200903009
Product description:	: FAUCET
Inspection Date:	: xx-xx-2011

### Inspection Method Applied: ( ANSI / ASQ Z1.4- 2008 )

Single Sampling Plans for Normal Inspection:	<input type="checkbox"/> S-4 / <input type="checkbox"/> L- I / <input checked="" type="checkbox"/> L- II / <input type="checkbox"/> Special:
Acceptance Quality Level (AQL) for:	Critical: N/A
	Major 2.5
	Minor 4.0

### Inspection Criteria :

<input checked="" type="checkbox"/> Purchase Order	<input checked="" type="checkbox"/> Reference sample	<input checked="" type="checkbox"/> Product Specifications	<input checked="" type="checkbox"/> Artwork	<input checked="" type="checkbox"/> Other documents	<input type="checkbox"/> N/A
--	--	--	---	---	------------------------------

### Overall Result: ☐ PASS ☒ FAIL ☐ PENDING ☐ ABORTIVE

INSPECTION RESULT			
Part 1 – PO Quantity & Availability	<input checked="" type="checkbox"/> Conformed	<input type="checkbox"/> Not Conformed	<input type="checkbox"/> Pending
Part 2 - Appearance, Functioning and Workmanship	<input type="checkbox"/> Conformed	<input checked="" type="checkbox"/> Not Conformed	<input type="checkbox"/> Pending
Part 3 - Field tests	<input type="checkbox"/> Conformed	<input checked="" type="checkbox"/> Not Conformed	<input type="checkbox"/> Pending
Part 4 - Packaging and Product Conformity	<input checked="" type="checkbox"/> Conformed	<input type="checkbox"/> Not Conformed	<input type="checkbox"/> Pending
Part 5 - Data measurement	<input checked="" type="checkbox"/> Conformed	<input type="checkbox"/> Not Conformed	<input type="checkbox"/> Pending

### Special Attention:

1. Fail Reason Highlight:	1, AQL Failed 2, Size not conform to spec
2. Pending Reason Highlight:	1, actual available quantity is item 979958: 1410pcs / 141ctns 979959: 468pcs / 39ctns 979960: 504pcs / 42ctns 979961: 1580pcs / 158ctns, not conform to PO, confirmed by Client, inspector goes ahead according to actual quantity 2, the factory could not provide suitable equipment for plating thickness checking
3. Informative Remark:	1, Total 20ctns selected cartons randomly selected, carton numbers: Item 979958: 95 70 14 44 31 89 56 61 979959: 9 30 979960: 35 36 979961:124 71 64 35 115 78 36 6 2, 1pc defect sample sealed in factory

Inspector Signature : XXX

Factory Signature : XXX



## 1. PO Quantity &amp; Availability:

☒ Conformed ☐ Not Conformed ☐ Pending

Article	PO No.	PO QTY	Booked QTY	Actual QTY	% Finished	% Packed
979958	S200903009	1500	1500	1410	94%	94%
979959	S200903009	504	504	468	93%	93%
979960	S200903009	504	504	504	100%	100%
979961	S200903009	2000	2000	1580	79%	79%
<b>Total:</b>		4508	4508	3962	Under 100%	Under 80%

2. AQL ( Workmanship appearance & Function inspection findings) ☐ Conformed ☒ Not Conformed ☐ Pending

Defect description	Critical	Major	Minor
For item 979958 s/s:80pcs			
Burr remain on bottom of faucet	0	0	11
Scratch mark on faucet	0	0	1
For item 979959 s/s:24pcs			
Dent mark on product	0	0	2
Water remain on product	0	0	1
For item 979960 s/s:24pcs			
Flash on product	0	0	1
For item 979961 s/s:72pcs			
Burr remain on bottom of faucet	0	0	9
<b>Total defectives:</b>	0	0	25
<b>Maximum allowed:</b>	0	7	14

## 3. Field Test / On Site Test Results:

☒ Conformed ☐ Not Conformed ☐ Pending

Article	Test item	Sample size	Result	Remark / Findings
All items	Assembly check	8	Acceptable	
All items	Function check under 4bar water pressure	8	Acceptable	
All items	Leakage test under 16bar water pressure	2pcs per items	Acceptable	
All items	Barcode scan	20	Readable	
All items	Odor check	10	No odour found	
All items	Batch code check	1pc per item	20110725/30009	

## 4. Packaging &amp; Product Conformity

☒ Conformed ☐ Not Conformed ☐ Pending

Article	QTY/ CTN	QTY/ Inner	Shipping Mark	Products	Bar Code On Unit	Bar Code On carton	Bar code Readable
	X- Ply	X- Ply					
979958	2-Ply	2-Ply	Pass	Pass	3276200402358	03276200402365	Readable
979959	2-Ply	2-Ply	Pass	Pass	3276200402327	03276200402334	Readable



979960	2-Ply	2-Ply	Pass	Pass	3276200402297	03276200402303	Readable
979961	2-Ply	2-Ply	Pass	Pass	3276200402266	03276200402273	Readable

Remark: compare with client' ref sample, artwork, shipping mark, PO.

SHIPPING MARK ( MAIN MARK )	SHIPPING MARK ( SIDE MARK )

## 5. Product Size & Weight Check

☐ Conformed ☒ Not Conformed ☐ Pending

L,W, H: For Length, Width, Height, Unit: mm

Wt: For Weight, Unit: kg

Article	Data In PO/ Ref. Sample				Sample 1				Sample 2				Sample3			
	L	W	H	Wt( body )	L	W	H	Wt	L	W	H	Wt	L	W	H	Wt
979958	238/238	128/130	61.5/43	0.404	238	130	43	0.415	238	130	43	0.410	238	130	43	0.413
979959	212/212	169/170	151/150	0.789	212	170	150	0.782	212	170	150	0.784	212	170	150	0.783
979960	212/212	171/171	102/102	0.432	212	171	102	0.446	212	171	102	0.443	212	171	102	0.445
979961	215/215	128/117	61.5/44	0.394	215	117	43	0.394	215	117	43	0.395	215	117	43	0.393

Note: client tolerance +/-2mm for size, +/-5% for weight

## Carton Size & Weight Check

L,W, H: For Length, Width, Height, Unit: CM

Wt: For Weight, Unit: KG

Article	Data In PO				Outer Carton 1				Outer Carton 2				Pallet			
	L	W	H	Wt	L	W	H	Wt	L	W	H	Wt	L	W	H	Wt
979958	/	/	/	/	30	29	34	8.8	30	29	34	8.9	/	/	/	/
979959	/	/	/	/	43	34.5	37	13.7	43	34.5	37	13.6	/	/	/	/
979960	/	/	/	/	34	23	31	8.2	34	23	31	8.1	/	/	/	/
979961	/	/	/	/	30	27	39	7.5	30	27	39	7.5	/	/	/	/

Remark: compare with client' PO data.



6. Attachment



979958-def- scratch mark.jpg



979958-def-burr remain on bottom of faucet.jpg



979958-def-burr remain on bottom of faucet (1).jpg



979958-def-burr remain on bottom of faucet (2).jpg



979958-def-burr remain on bottom of faucet (3).jpg



979958-def-burr remain on bottom of faucet (4).jpg





979958-def-burr remain on bottom of faucet (5).jpg



979958-def-burr remain on bottom of faucet (6).jpg



979958-def-burr remain on bottom of faucet (7).jpg



979958-def-burr remain on bottom of faucet (8).jpg



979958-def-burr remain on bottom of faucet (9).jpg



979958-def-burr remain on bottom of faucet (10).jpg



979959-def-scratch mark-1.jpg



979959-def-scratch mark-2.jpg



979959-def-water on faucet.jpg



979960-def-flash on product.jpg



979961-def-burr remain on bottom of faucet.jpg



979961-def-burr remain on bottom of faucet (1).jpg





979961-def-burr remain on bottom of faucet (2).jpg



979961-def-burr remain on bottom of faucet (3).jpg



979961-def-burr remain on bottom of faucet (4).jpg



979961-def-burr remain on bottom of faucet (5).jpg



979961-def-burr remain on bottom of faucet (6).jpg



979961-def-burr remain on bottom of faucet (7).jpg



979961-def-burr remain on bottom of faucet (8).jpg



979958-function.JPG



979958-leakage test.JPG



979959- function.JPG



979959- function 2.JPG





979959-leakage.JPG



979959-leakage 2.JPG



979960- (20)function.JPG



979960- (21)leakage test.JPG



979961- (21)function.JPG



979961- (22)leakage test.JPG



sealed defects sample.JPG



979958- (1)ctn.JPG



979958- (2)shipping mark.JPG



979958- (3)ctn barcode.JPG



979958- (4)packing.JPG





979958- (5)marking on box.JPG

979958- (6)unit bar.JPG

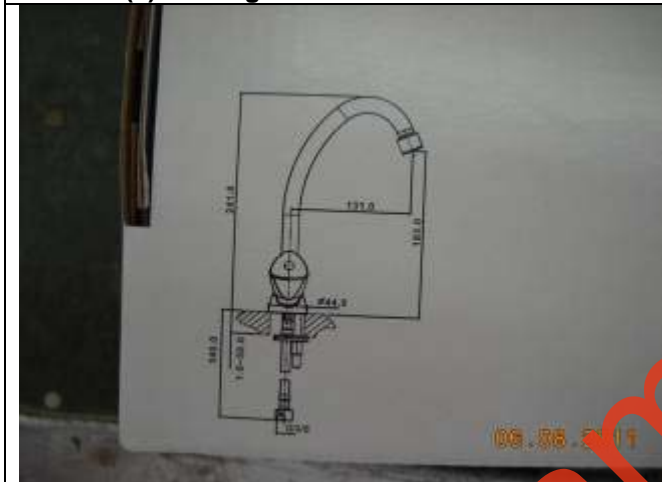

979958- (7)marking on box.JPG

979958- (8)marking on box.JPG

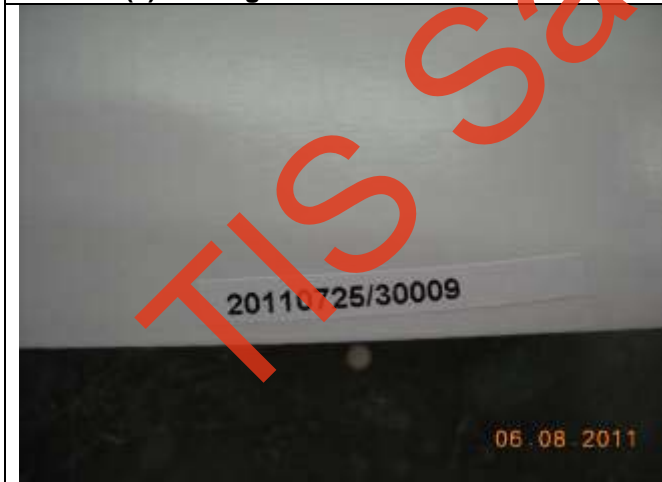

979958- (9)batch code.JPG

979958- (10)packing.JPG



979958- (11)ref and product.JPG



979958- (12)ref and product.JPG



979958- (13)packing.JPG

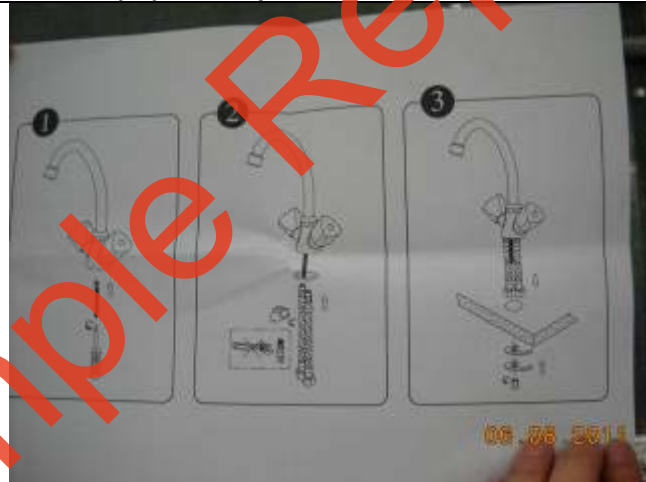

979958- (14)instruction.JPG



979958- (15)parts.JPG



979958- (16)product.JPG





979958- (17)weight.JPG



979958- (18)weight.JPG



979958- (19)product.JPG



979958- (20)product.JPG



979958- (21)red and blue button.JPG



979958-batch code.JPG



979958-ref weight.JPG

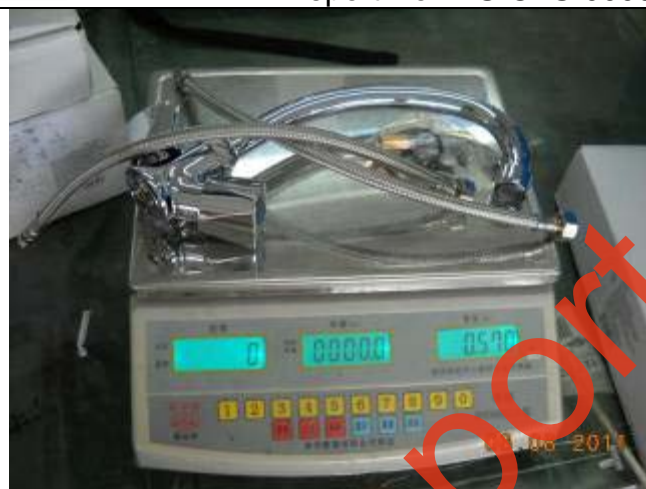

979958-ref weight 2.JPG



979959- (1)ctn.JPG



979959- (2)shipping mark.JPG



979959- (3)ctn bar.JPG



979959- (4)packing.JPG





979959- (5)marking on box.JPG

979959- (6)unit bar.JPG

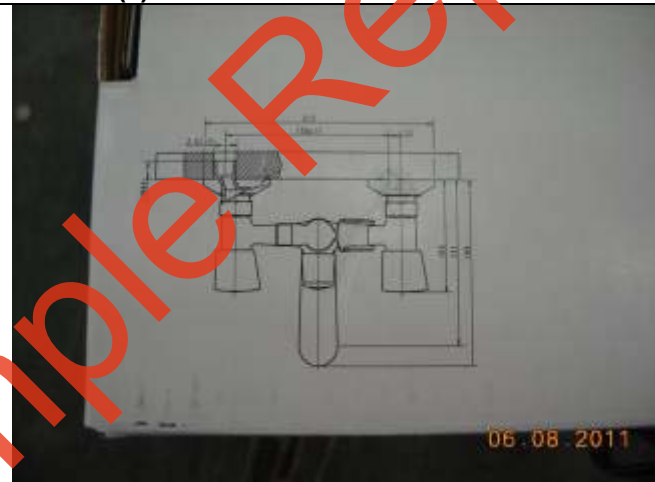

979959- (7)marking on box.JPG

979959- (8)marking on box.JPG



979959- (9)batch code.JPG

979959- (10)ref and product.JPG



979959- (11)ref and product.JPG



979959- (12)packing.JPG



979959- (13)weight.JPG



979959- (14)weight.JPG



979959- (15)product.JPG



979959- (16)product.JPG





979959- (17)product.JPG

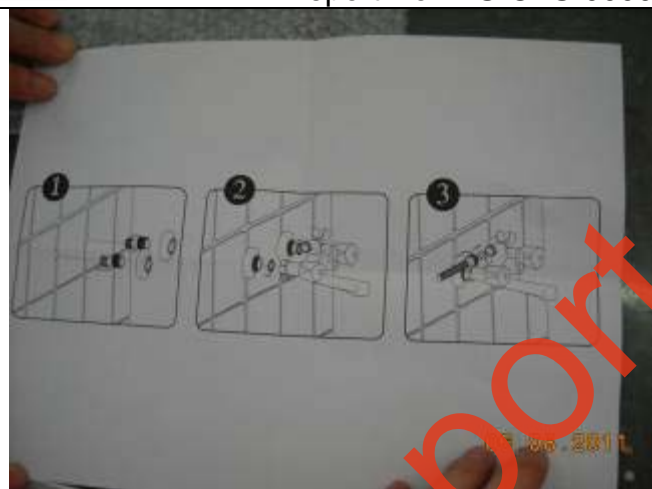

979959- (18)instruction.JPG



979959- ref weight.JPG



979959- ref weight 2.JPG



979959-batch code.JPG



979960- (1)shipping mark.JPG



979960- (2)ctn barcode.JPG

979960- (3)packing.JPG



979960- (4)marking on box.JPG

979960- (5)unit bar.JPG



979960- (6)marking on box.JPG

979960- (7)marking on box.JPG





979960- (8)batch code.JPG



979960- (9)ref and product.JPG



979960- (10)ref and product.JPG

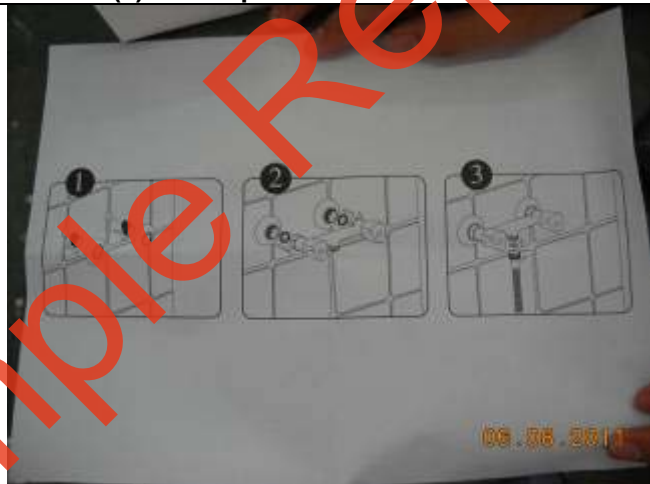

979960- (11)instruction.JPG



979960- (12)product.JPG



979960- (13)product.JPG



979960- (14)weight.JPG



979960- (15)weight.JPG



979960- (16)product.JPG



979960- (17)batch code.JPG



979960- (18)ref and product.JPG



979960- (19)ref and product.JPG





**979960-ctn.JPG**



979961- (1)shipping mark.JPG



979961- (2)ctn bar.JPG



979961- (3)packing.JPG



**979961- (4)marking on box.JPG**



979961- (5)unit bar.JPG

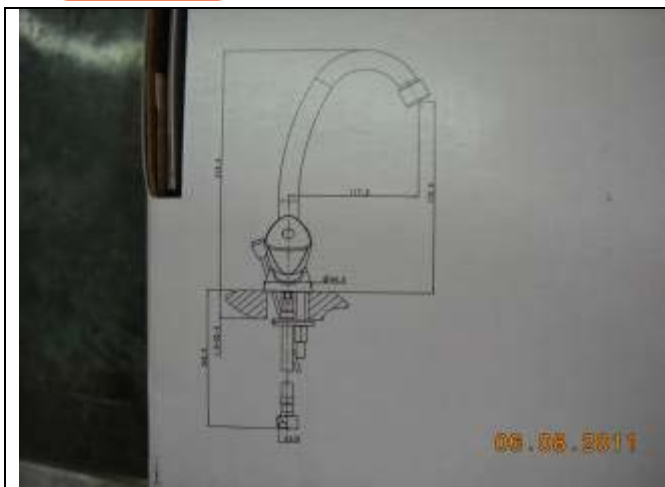

979961- (6)marking on box.JPG

979961- (7)marking on box.JPG



979961- (8)batch code.JPG

979961- (9)packing.JPG



979961- (10)instruction.JPG

979961- (11)parts.JPG





979961- (12)button on product.JPG



979961- (13)weight.JPG



979961- (14)weight.JPG



979961- (15)product.JPG



979961- (16)batch code.JPG



979961- (17)ref and product.JPG



979961- (18)ref and product.JPG



979961- (19)ref weight.JPG



979961- (20)ref weight.JPG



979961-ctn.JPG

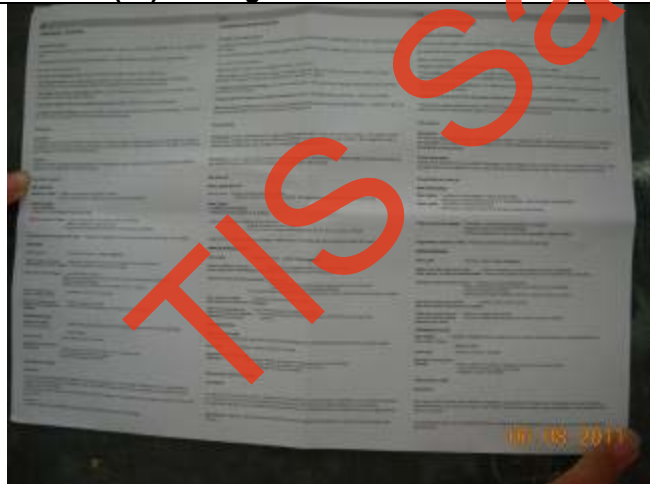

instruction for all.JPG



instruction for all (1).JPG





instruction for all (2).JPG

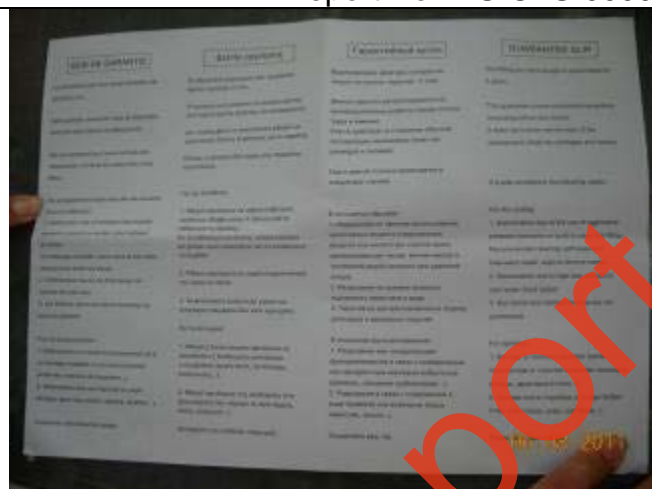

instruction for all (3).JPG

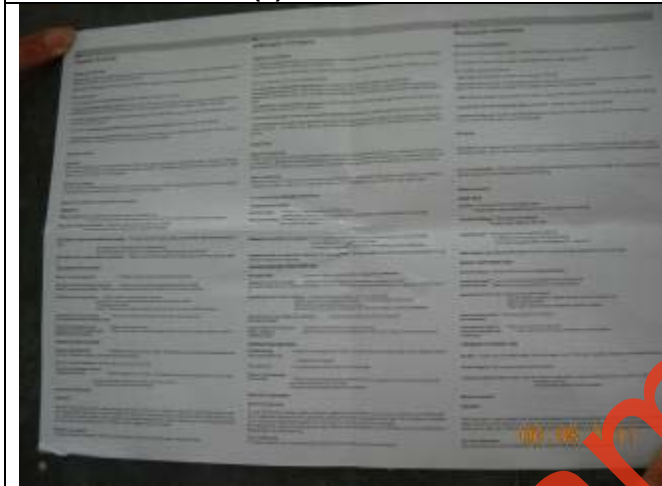

instruction for all (4).JPG

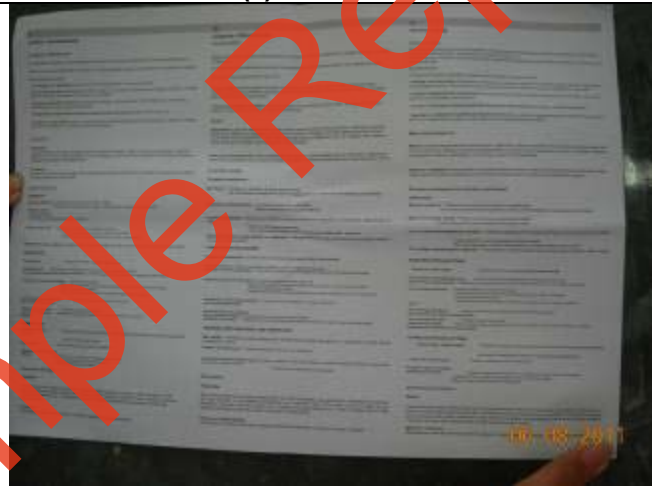

instruction for all (5).JPG



marking on hose.JPG



marking on hose (1).JPG

end